

S Style Turning Inserts

SNG

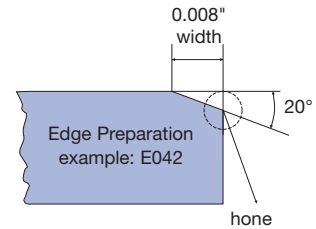
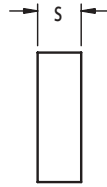
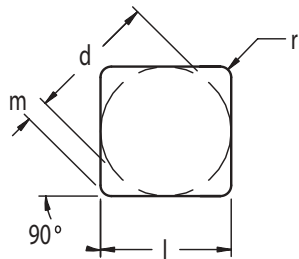

Part Number		Dimensions (inch)							Grade					
ANSI	ISO	d	l	s	r	m	m1	h	SA7402		SA8204		SA8405	
									Stock	Edge Prep	Stock	Edge Prep	Stock	Edge Prep
SNG321	<i>SNGN090304</i>	0.375	0.375	0.125	0.016	0.071	-	-	◆◆◆	E022	-	-	-	-
SNG322	<i>SNGN090308</i>	0.375	0.375	0.125	0.031	0.065	-	-	◆◆◆	E022	◆◆	E020	-	-
SNG323	<i>SNGN090312</i>	0.375	0.375	0.125	0.047	0.058	-	-	◆◆◆	E022	-	-	-	-
SNG332	<i>SNGN090408</i>	0.375	0.375	0.188	0.031	0.065	-	-	◆◆◆	E022	-	-	-	-
SNG335	<i>SNGN090420</i>	0.375	0.375	0.188	0.079	0.044	-	-	◆◆◆	E022	-	-	-	-
SNG422	<i>SNGN120308</i>	0.500	0.500	0.125	0.031	0.091	-	-	◆◆◆	E042	-	-	-	-
SNG431	<i>SNGN120404</i>	0.500	0.500	0.188	0.016	0.097	-	-	◆◆◆	E042	-	-	-	-
SNG432	<i>SNGN120408</i>	0.500	0.500	0.188	0.031	0.091	-	-	◆◆◆	E042	◆◆	E040	-	-
SNG433	<i>SNGN120412</i>	0.500	0.500	0.188	0.047	0.084	-	-	◆◆◆	E042	◆◆	E040	◆◆	E020
SNG434	<i>SNGN120416</i>	0.500	0.500	0.188	0.063	0.077	-	-	◆◆◆	E042	◆◆	E040	◆◆	E020
SNG435	<i>SNGN120420</i>	0.500	0.500	0.188	0.079	0.071	-	-	◆◆◆	E042	-	-	-	-
SNG452	<i>SNGN120708</i>	0.500	0.500	0.313	0.031	0.091	-	-	◆◆◆	E042	◆◆	E040	◆◆	E020
SNG453	<i>SNGN120712</i>	0.500	0.500	0.313	0.047	0.084	-	-	◆◆◆	E042	◆◆	E040	◆◆	E020
SNG454	<i>SNGN120716</i>	0.500	0.500	0.313	0.063	0.077	-	-	◆◆◆	E042	◆◆	E040	◆◆	E020
SNG455	<i>SNGN120720</i>	0.500	0.500	0.313	0.079	0.071	-	-	◆◆◆	X433	◆◆	X433	-	-
SNG552	<i>SNGN150708</i>	0.625	0.625	0.313	0.031	0.117	-	-	◆◆◆	E042	-	-	-	-
SNG553	<i>SNGN150712</i>	0.625	0.625	0.313	0.047	0.110	-	-	◆◆◆	E042	◆◆	E040	-	-
SNG554	<i>SNGN150716</i>	0.625	0.625	0.313	0.063	0.104	-	-	◆◆◆	E042	◆◆	E040	-	-
SNG643	<i>SNGN190612</i>	0.750	0.750	0.250	0.047	0.136	-	-	◆◆◆	X542	◆◆	X433	-	-
SNG653	<i>SNGN190712</i>	0.750	0.750	0.313	0.047	0.136	-	-	◆◆◆	X433	-	-	-	-
SNG654	<i>SNGN190716</i>	0.750	0.750	0.313	0.063	0.130	-	-	◆◆◆	X433	◆◆	X433	-	-
SNG655	<i>SNGN190720</i>	0.750	0.750	0.313	0.079	0.122	-	-	◆◆◆	X433	-	-	-	-
SNG855	<i>SNGN250720</i>	1.000	1.000	0.313	0.079	0.175	-	-	◆◆◆	X635	-	-	-	-

Star Guide Key to Recommended Inserts

Ordering example: SNG 855 SA7402

Material Designations					
	P ◆◆ Unalloyed Steels	M ◆◆ Stainless Steels	K ◆◆ Cast Irons	S ◆◆ High Temp. Alloys	
	P ◆◆ Alloyed Steels	M ◆◆ PH Stainless	N ◆◆ Aluminium & Alloys	H ◆◆ Hard Materials	

